

# Pioneer Crossing East

Austin, Texas 78754

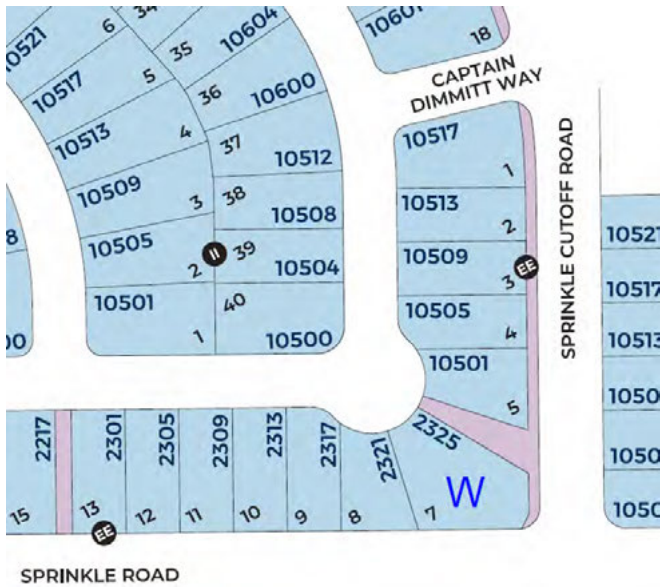

| PLAN/ELEV       | ADDRESS                   | SQ. FT. | STORY | BED | BATH | PRICE     | CABINET COLOR |
|-----------------|---------------------------|---------|-------|-----|------|-----------|---------------|
| The Wilson II B | 2325 Alamo Heights Avenue | 2557    | 2     | 4   | 3    | \$618,490 | Stone         |



Jim Calvert · [jncalvert@drhorton.com](mailto:jncalvert@drhorton.com) · 512.913.2192

Cindy Mitchell - [chmitchell@drhorton.com](mailto:chmitchell@drhorton.com) - 512.589.1749

Pat Ware - [pware@drhorton.com](mailto:pware@drhorton.com) - 512.799.8673

Pioneer Crossing East · 10928 Defender Trail, Austin, TX. 78754 · (512) 605.0406 · [drhorton.com/austin](http://drhorton.com/austin)



Prices, plans, features, and co-broke are subject to change without notice. Additional restrictions may apply. Square footages are approximate. Prices shown are base home prices and do not include closing costs and fees, modifications to plans and custom features which may substantially affect the cost of the home. Homes are subject to availability and feasibility. Estimated dates are projections only and subject to change. Home and community information, including pricing, included features, terms, availability and amenities, are subject to change and prior sale at any time without notice or obligation. Pictures, photographs, colors, features, and sizes are for illustration purposes only and will vary from the homes as built. Buyer should conduct his or her own investigation of the present and future availability of school districts and school assignments. D.R. Horton has no control or responsibility for any changes to school districts or school assignments should they occur in the future. D.R. Horton, Inc.